

Metal Ceramic Connections 2kV to 10kV

BENEFITS

- High grade materials allow repeated bakings up to 400° C
- 2011/65/EU RoHS compliant



ORDER INFORMATION

Type	3 kV	2 kV	5 kV	10 kV
UMK 002 Metal-ceramic	214-161			
UMK 006 Metal-ceramic		214-162		
UMK 106 Metal-ceramic			214-163	
UMK 112 Metal-ceramic				214-164

SPECIFICATIONS

Type		3 kV	2 kV	5 kV	10 kV
Voltage (1)		3 kV	2 kV	5 kV	10 kV
Insulator		Al ₂ O ₃	Al ₂ O ₃	Al ₂ O ₃	Al ₂ O ₃
Connection					
a		Fe-Ni	Fe-Ni	Fe-Ni	Fe-Ni
b		Fe-Ni	stainless steel, 304/1.4301	stainless steel, 304/1.4301	stainless steel, 304/1.4301
Bakeout temperature	°C	400	400	400	400
Tightness	mbar•L/s	5 x 10 ⁻¹¹	5 x 10 ⁻¹¹	5 x 10 ⁻¹¹	5 x 10 ⁻¹¹
Weight	kg	0.005	0.012	0.025	0.09

(1) Based on VDC 0110 for air and surface-leakage in atmosphere on both sides.

Higher values up to factor two are admissible in pressure <10⁻⁴ mbar.

DIMENSIONS

214-161

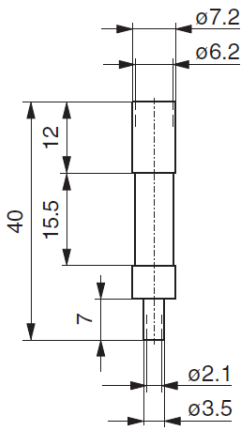

214-162

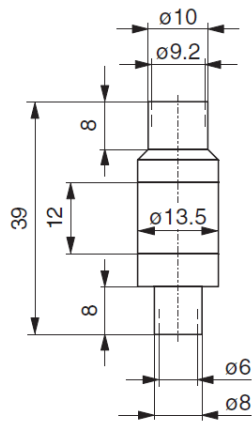

214-163

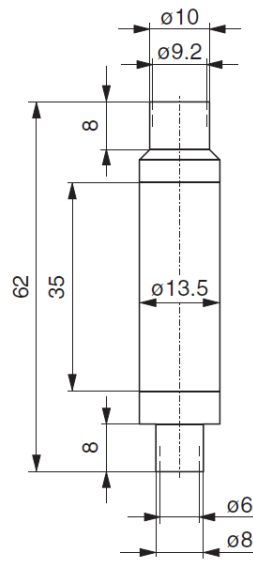

214-164

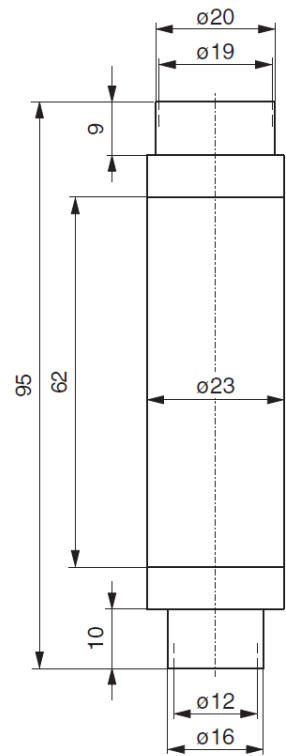

[mm]



www.inficon.com reachus@inficon.com

Due to our continuing program of product improvements, specifications are subject to change without notice. RateWatcher is a trademark of INFICON. All other trademarks are the property of their respective owners.

(2016-08) © 2016 INFICON